



the balustrade system

a system approach to glass balustrading

various fixing details for **on slab** or **slab edge** fixing

Fully tested line loadings **up to 3.0kN**

Frameless or with a 16mm **hand rail**

A **range of finishes** available including anodising

toughened laminated glass for strength and security

efficient manufacturing + lead times

the balustrade system

Technical Data Sheet

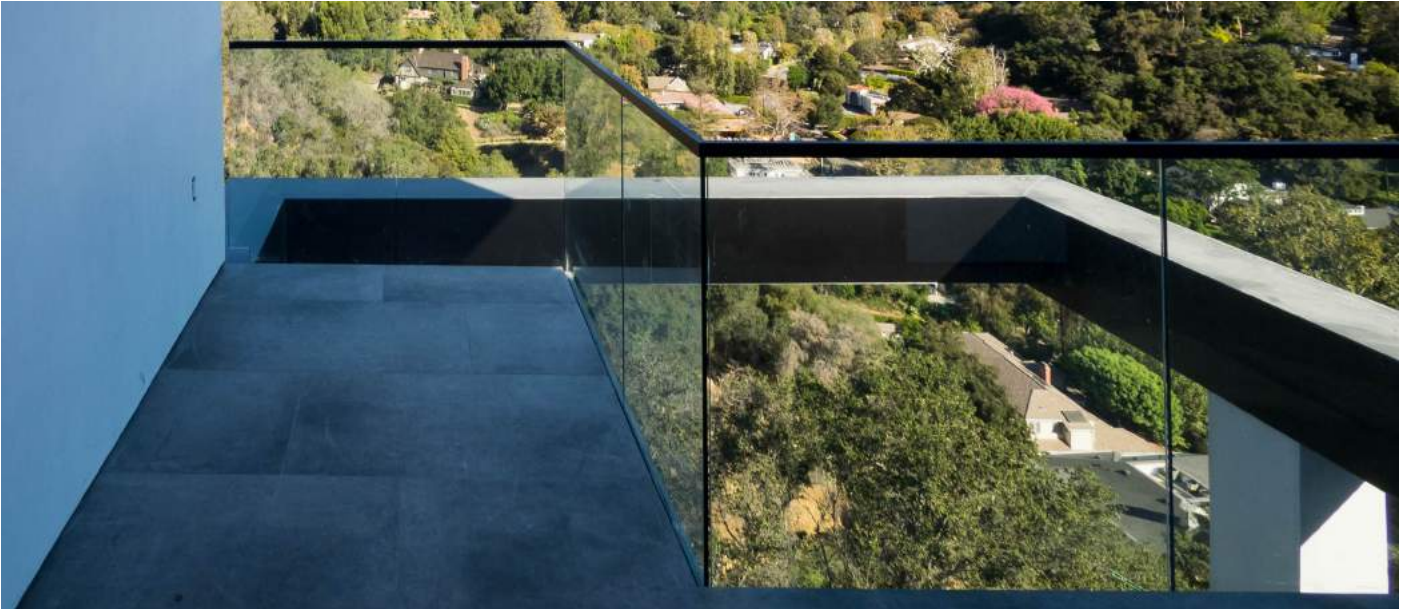

The Sieger Balustrade System is available in two design options; a frameless balustrade or a minimally framed design with a handrail.

Glass Specification

Frameless Balustrade design

2x10 TXD with 1.5 SGP interlayer

Balustrade with handrail (for 0.74 kN line load)

2x8 TXD with 1.5 PVB laminate

Balustrade with handrail (up to 3 kN line load)

2x10 TXD with 1.5 PVB laminate

Glass Thickness up to 21.5mm

Available on request curved glass, low iron glass, low maintenance coatings, coloured/ decorative interlayers, anti-reflective glass and more

Maximum Sizes

Width maximum pane widths are calculated on a project by project basis, generally the maximum size is 6m per pane (wider is available upon

application)

Height 1.1m max. in conjunction with regulation balustrade heights

Handrails

2x8 glass spec 22mm wide x 16mm tall

2x10 glass spec 26mm wide x 20mm tall

Handrail Finishes

Base and handrail finishes in same colour Powder coated and RAL colour, specialist metallic finishes, anodised, timber effect finish





Line Loading

Balustrades are designed to the required line loading for the project. See pages 4–6 for line loading requirements.

Fixings

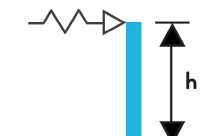
See pages 7–9.

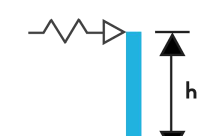
the balustrade system

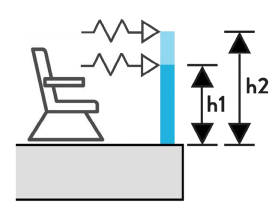
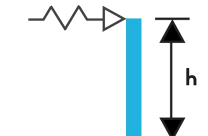
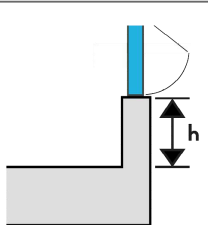
building category and location		Height (h) of balustrade	
Single family dwellings	Stairs, landings, ramps, edges of internal floors	900mm	
	External balconies, including Juliette balconies and edges of roof	1100mm	
Factories and warehouses (light traffic)	Stairs, ramps	900mm	
	Landings and edges of floors	1100mm	
Residential, institutional, educational, office and public buildings	All locations	900mm for flights, otherwise 1100mm	
Assembly	Within 530mm in front of fixed seating	800mm (h1)	
	All other locations	900mm for flights elsewhere 1100mm (h2)	
Retail	All locations	900mm for flights, otherwise 1100mm	
Glazing in all buildings	At opening windows except roof windows in loft extensions (see Approved Document B1)	800mm	

the balustrade system

Line Load Requirements for Buildings

Building Occupancy Class		Line Load (applied 1100mm above FFL)	UDL (applied to entire glass face, below line load height)	Concentrated Load (applied to any part of the glass panel below line load)
1	Domestic and Residential – single family dwellings Office and Work Areas – light pedestrian traffic routes	0.36 kN/m	0.5 kN/m ²	0.25 kN
2	Domestic and Residential – multi-occupancy, balconies and edges of roofs Office and Work Areas – areas not susceptible to over crowding Areas without obstacles for moving people and not susceptible to over crowding – stairs, landing, corridors, and balconies	0.74 kN/m	1.0 kN/m ²	0.5 kN
3	Areas where people might congregate – areas having fixed seating within 530mm of the barrier Areas with tables or fixed seating – restaurants and bars Areas susceptible to over crowding – footways or footpaths less than 3 metres wide, adjacent to sunken areas Retail areas – all retail areas including banks, building societies or betting shops	1.5 kN/m	1.5 kN/m ²	1.5 kN
4	Areas susceptible to over crowding – theatres, cinemas, shopping malls, assembly areas. Footways or pavements greater than 3 metres wide adjacent to sunken areas	3.0 kN/m	1.5 kN/m ²	1.5 kN

the balustrade system

Tested Line Loadings

Fixing Name	Fixing Example	Line Load	Drainage Profile Available?
Over Slab Fixing		Up to 0.8 kN	✓
Slab Edge Fixing		Up to 3 kN	✓
Offset Over Slab Fixing		Up to 3 kN	✓

the sieger[®] balustrade system

tested line loads

category of use		subcategory of use		horizontal force test	normal fixing	HD fixing
A	residential areas	A1	residences and room areas in hospitals and hotels	0.8 kN/m	✓	✓
		A2	storage	0.8 kN/m	✓	✓
B	administrative areas			0.8 kN/m	✓	✓
C	public access areas (except areas belonging to cat A, B and D)	C1	areas with tables and chairs	0.8 kN/m	✓	✓
		C2	areas with fixed seats	0.8 kN/m	✓	✓
		C3	areas without obstacles which block the access to halls in public and administrative buildings, hotels, exhibition rooms in museums etc.	1.6 kN/m		✓
		C4	areas for physical activities and gyms	1.6 kN/m		✓
		C5	crowded areas (concert halls, stadiums etc)	3.0 kN/m		✓
D	shopping areas	D1	business premises	0.8 kN/m	✓	✓
		D2	supermarkets, hypermarkets or department stores	0.8 kN/m	✓	✓
E	traffic and parking areas for light vehicles (total weight < 30 kN)			1.6 kN/m		✓
F	weight-bearing roofs with private access			1.6 kN/m		✓
G	roofs accessible for conservation	G1	roof with inclination < 20 degrees	0.8 kN/m	✓	✓
			light roof (without slab)	0.8 kN/m	✓	✓
		G2	roof with inclination > 40 degrees	0.8 kN/m	✓	✓

the balustrade system

Typical Framing Sections

OVER SLAB FIXING

For balustrades fixed to top of slab.

Maximum Line Load 0.8 kN

Overall Depth 46mm

Height 124.5mm

Drainage Profile Available? Yes

Glass Thickness up to 21.52mm

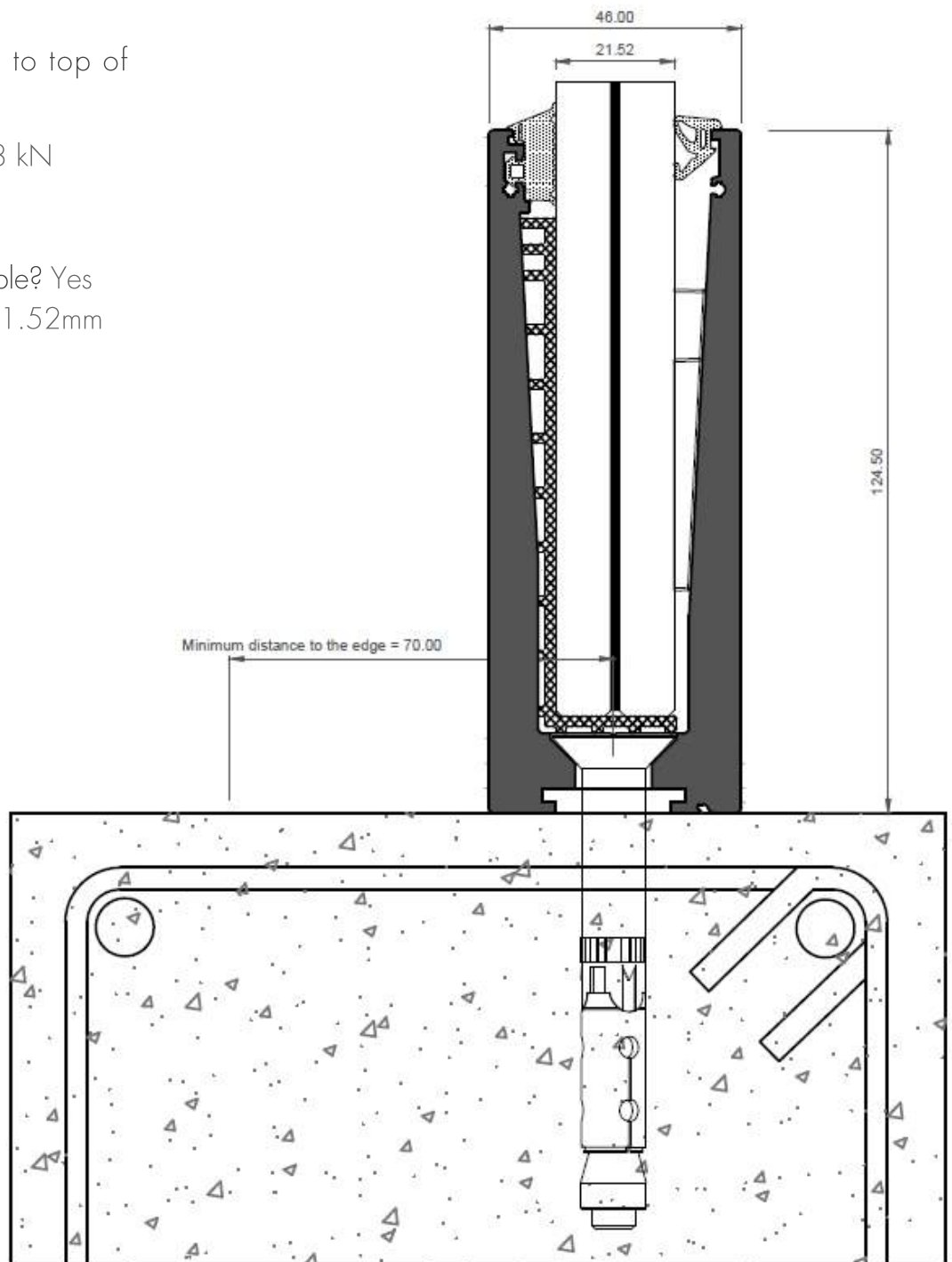

the balustrade system

Typical Framing Sections

SLAB EDGE FIXING

For balustrades fixed to the edge of the slab.

Maximum Line Load 3 kN

Overall Depth 48.1 mm

Height 128.8 mm

Drainage Profile Available? Yes

Glass Thickness up to 21.52 mm

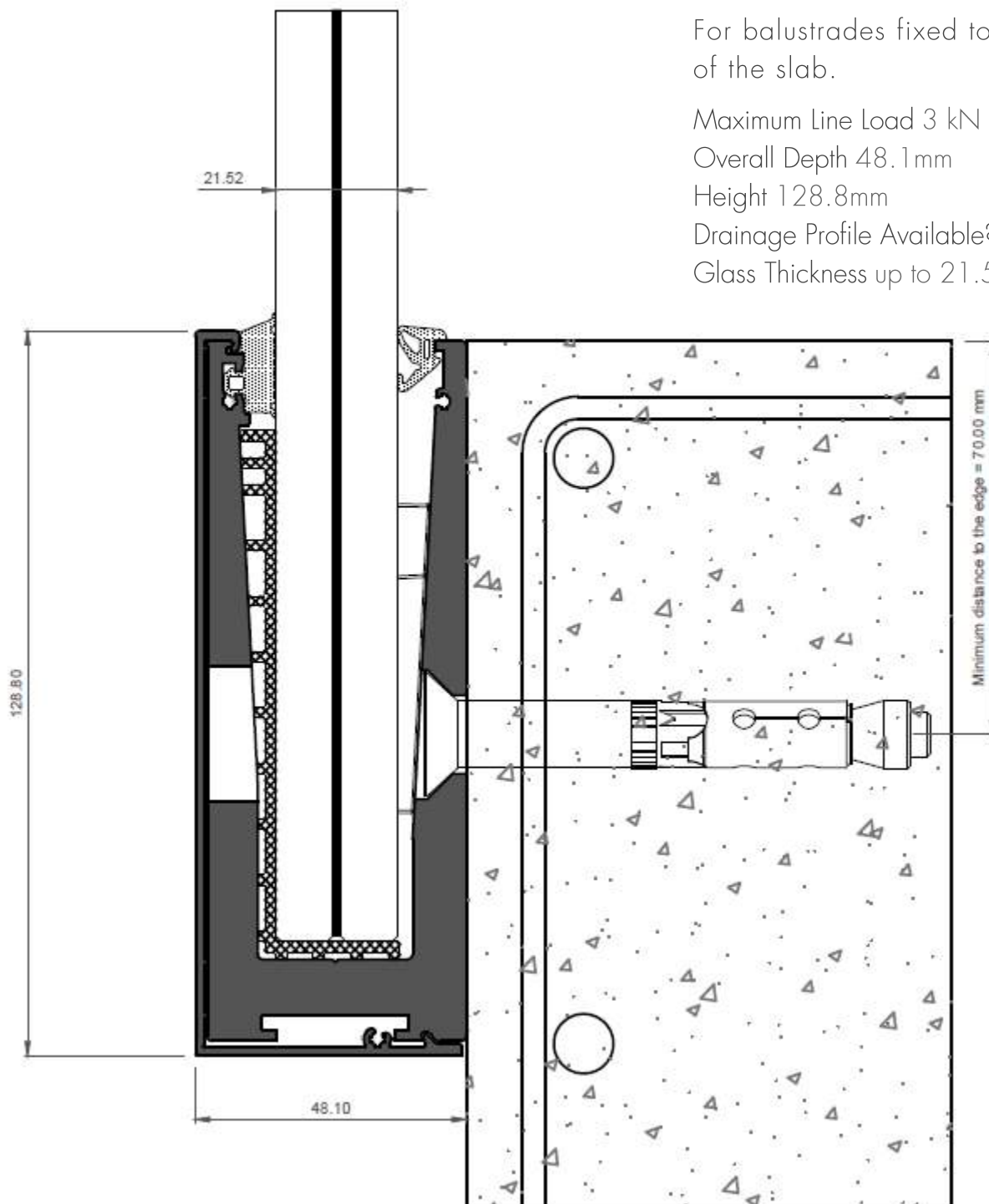

the balustrade system

Typical Framing Sections

OFFSET OVER SLAB FIXING

For balustrades flush with the edge of slab.

Maximum Line Load 3 kN

Overall Depth 91 mm

Height 124.5 mm

Drainage Profile Available? Yes

Glass Thickness up to 21.52 mm

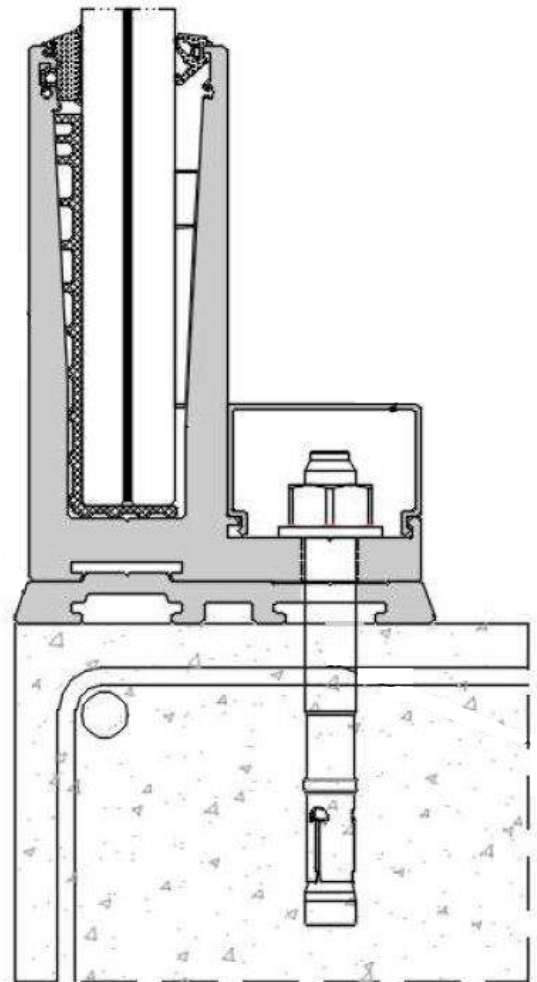
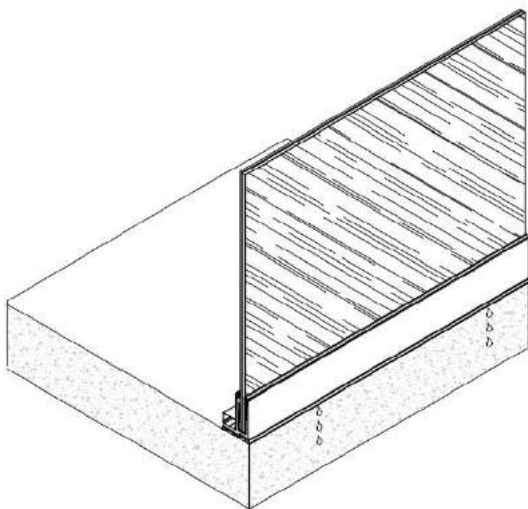

the balustrade system

Drainage Profiles

AVAILABLE ON SLAB EDGE
FIXING, OVER SLAB FIXING AND
OFFSET OVER SLAB FIXING

Designed to allow water from
balcony/terrace to drain through
balustrade fixing and away.

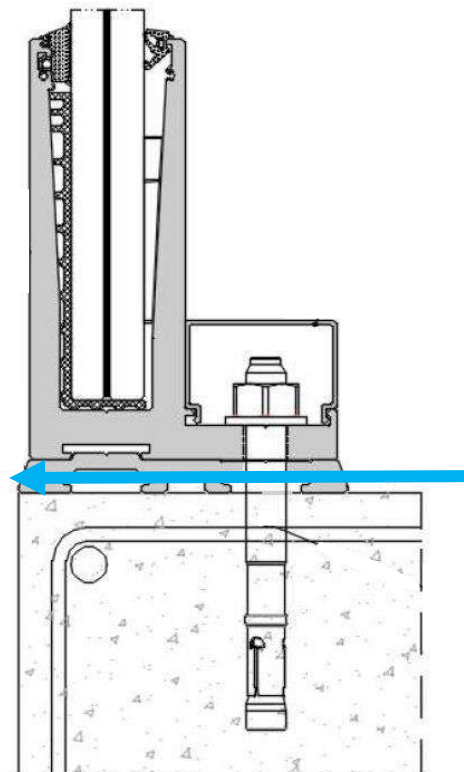
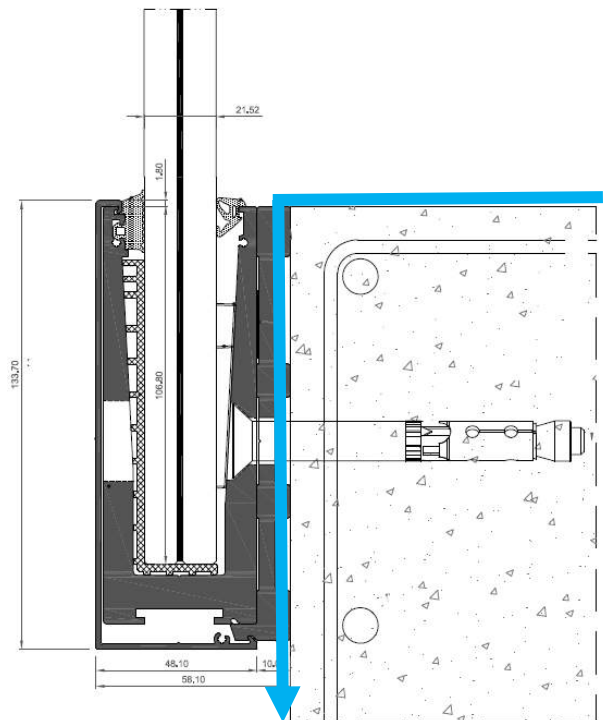
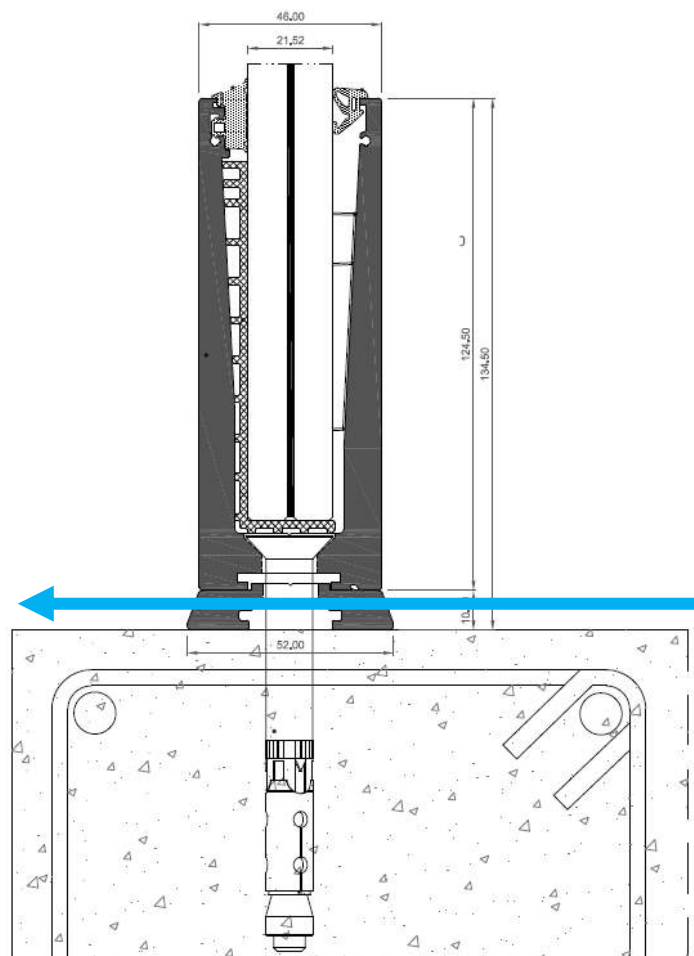

the balustrade system

At the Showroom



ON SHOW

The Sieger® Balustrade System is available to view in real size at the Sky House Design Centre in Amersham. The two design options (frameless or handrail option) are both available to view in person at the showroom.



SEE FINISHES + DETAILS

Seeing a picture or drawing of a potential building product is never the same as seeing it in person. When you visit the Sky House Design Centre you will see the exclusive Sieger® Range each finished in a range of ways with multiple ironmongery options.



VISIT

Contact your sales representative to arrange your personal appointment to the Sky House Design Centre and see the exclusive Sieger® Systems in real life.

the balustrade system

How to Specify

The Sieger® Architektursystem is available exclusively from the IQ Group and associated companies.

A Sieger® Systems product will bring high quality European engineering to your project and are the first choice for architects and designers all over the UK.

If you have any questions about how to specify this product for your project just speak to the team who would be happy to assist.

SPEAK TO THE TEAM

If you are considering using a Sieger® product on your project speak to the team at your chosen IQ Group glazing company. They will be able to advise you on the best solution for your intended design, ensure that all specification criteria are met and advise you on any feasibility areas of the installation you may not have considered.

GET A QUOTATION

We advise customers to get a quotation for the installation. This allows all parties to ensure that the preferred product and design is within budget. If it is not we can help you adjust the specification to reach all performance, design and budgetary requirements.

ADD US TO YOUR NBS SPECIFICATION

To assist you in specification we have created individual NBS Specification sheets for each Sieger® Systems product. These easy to navigate documents contain all the vital information needed for specification. They are available for your to complete on your own alternatively ask your sales representative at to complete this on your behalf.

PLACE THE ORDER

When ready you (or your client or the builder) can then place the order for your products with us. A full in house handover will take place and your project will be passed to the contracts team. The project will be appointed a dedicated contracts manager who will oversee the installation process. The estimated lead time for Sieger® products is 6-8 weeks but your overall glazing lead time may be different depending on the other glazing products on your project and their lead times. Please also allow 20 working days if your project requires full glazing design drawings. This will be confirmed on order.

WHERE CAN I SEE SIEGER PRODUCTS?

The Sieger® Systems range is available to view at the Sky House Design Centre. Just contact your sales representative who will be happy to book you an appointment.

the balustrade system

a system approach to glass
balustrading

EUROPEAN DESIGN

The Sieger® Architektursystem has been designed to the highest European standards to ensure a highly engineered finish with the best performance.

Each aluminium framing system is selected and engineered to offer a minimal and modern finish, whilst maintaining robust performance and quality standards.

BRITISH MANUFACTURING

Every Sieger® Architektursystem product is manufactured and fabricated bespoke to each project specification. Our state of the art fabrication site offers the latest technology in modern aluminium fabrication, ensuring Sieger® Systems can offer efficient lead times and exceptional quality.

MORE INFORMATION

For more information about the Sieger® Architektursystem please contact the team who will be happy to help. Make sure you investigate our entire range to achieve a cohesive design to all elements of your building project.

