

---

the legacy conservation rooflight



# the legacy conservation rooflight

Designed with high levels of insulation and weather resistance, this flush rooflight system boasts a modern and minimalistic design suitable for . With the ability to conceal the inner frame within the building finishes the internal view appears frameless, offering uninterrupted sky views without obstruction. This incredibly minimalistic design suits a wide range of buildings including residential extensions, new build houses, heritage and listed buildings.

sight-line	typical frame width	67mm
glass	typical thickness	39.5mm
	typical spec	DGU
max sizes	per pane	1500mm x 3000mm
	max no. of panes	no limit
frame	typical frame depth	67mm
	standard colours	PPC RAL 7016 / 9005
	other finishing options	any other RAL colour
shape	standard shapes	square / rectangular
	other	other shapes available on request
pitch	recommended	15 - 60 degrees

# the legacy conservation rooflight

This system can be configured as a singular rooflight,  
modular rooflight or an apex rooflight.

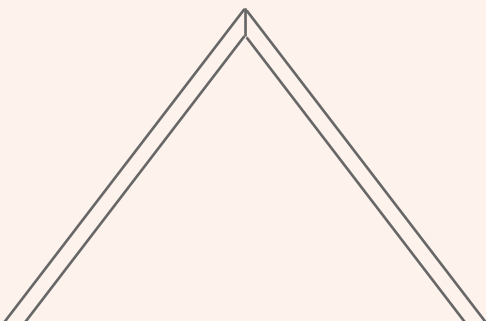
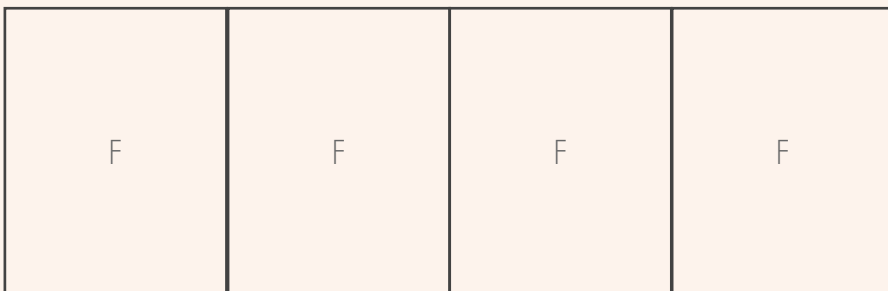
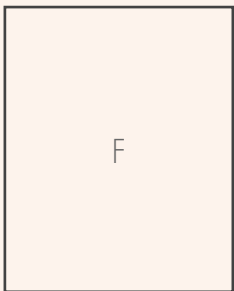

## the legacy conservation rooflight

By the use of minimal framing the conservation rooflight appears completely frameless internally. The external frame is visible however due to the super flush nature of this system it does not alter the external view of the roof.

Conservation rooflights are more popular on traditional or listed properties due to the flush finish with very minimal or no visible framing. Sieger are able to integrate glazed bars into the rooflight design to continue the more traditional design.

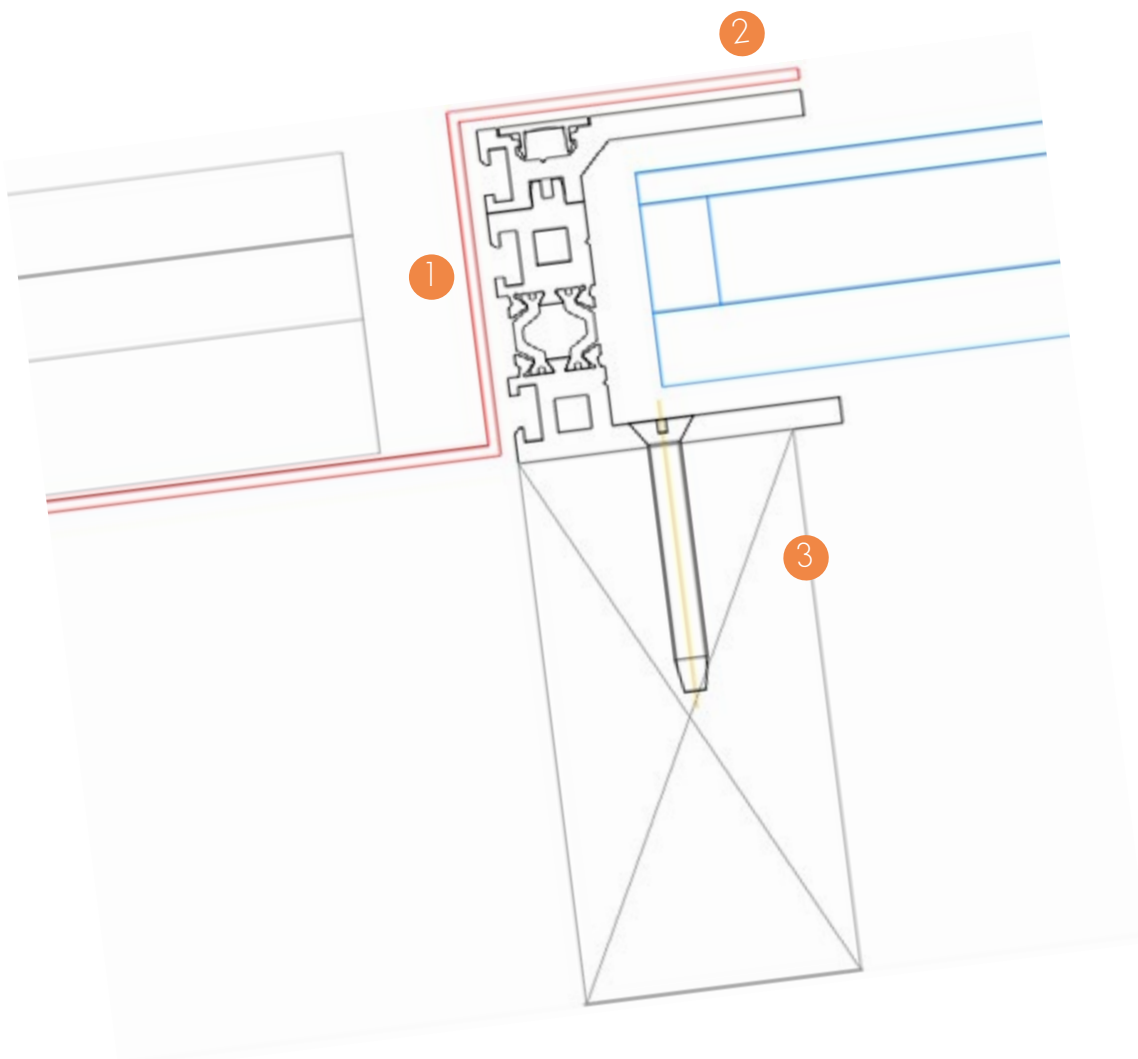

- ① typical frame depth 67mm
- ② typical frame width 60mm
- ③ inner frame concealed within building finishes

## the legacy conservation rooflight

Installing a rooflight onto your property is one of the best ways to bring natural light into a building discretely but effectively. These rooflights in particular can distribute light to low-level structures and can brighten darker areas of a room where windows may not reach.

By using an apex configuration this can help to maximise the amount of natural light flooding into the space below whilst providing striking sky views.

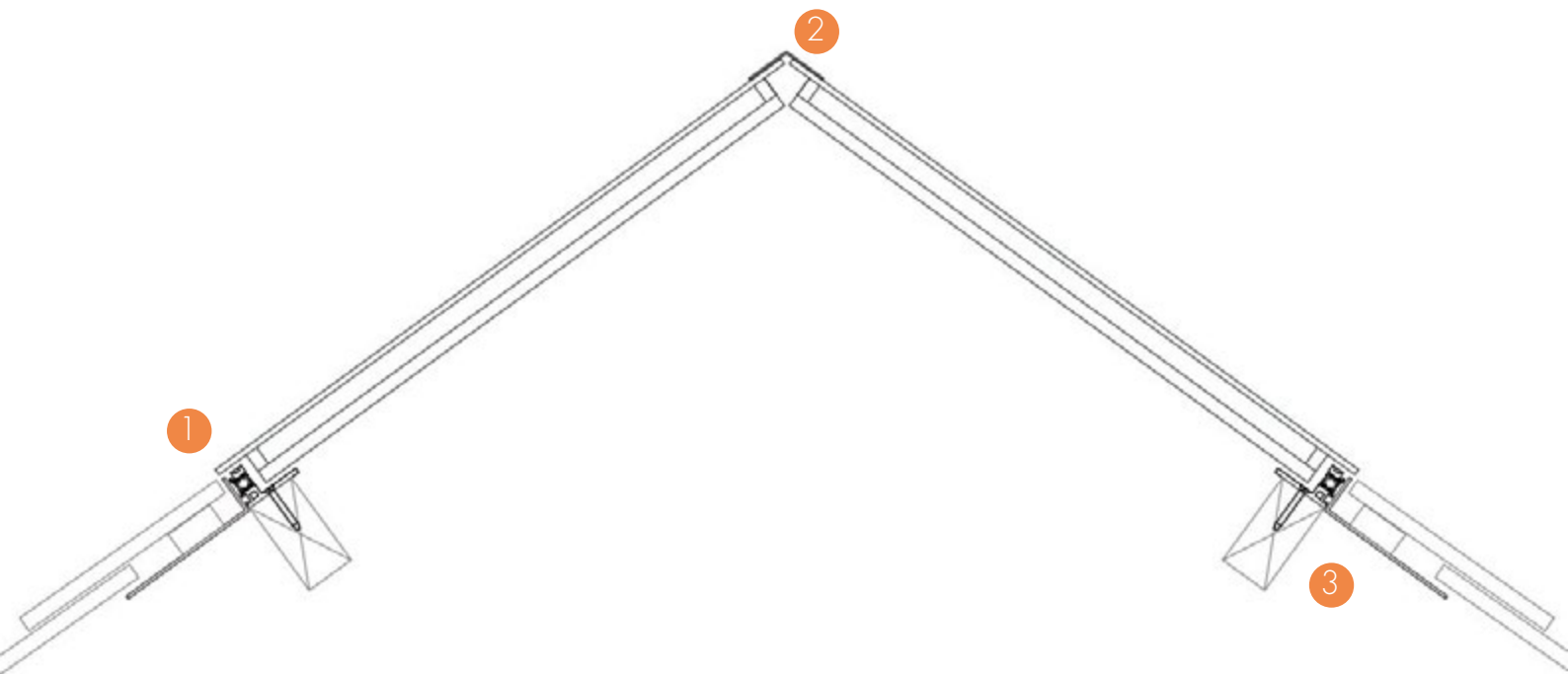

- 1 super flush design
- 2 aluminium capping at rooflight peak
- 3 inner frame concealed within building finishes



# the legacy conservation rooflight



Kandahar, Guernsey



# the legacy conservation rooflight



Forty Farm



# the legacy conservation rooflight

The Sieger® Architektursystem is available exclusively from the IQ Group and associated companies.

A Sieger® Systems product will bring high quality European engineering to your project and are the first choice for architects and designers all over the UK.

If you have any questions about how to specify this product for your project just speak to the team who would be happy to assist.

## SPEAK TO THE TEAM

If you are considering using a Sieger® product on your project speak to the team at your chosen IQ Group glazing company. They will be able to advise you on the best solution for your intended design, ensure that all specification criteria are met and advise you on any feasibility areas of the installation you may not have considered.

## GET A QUOTATION

We advise customers to get a quotation for the installation. This allows all parties to ensure that the preferred product and design is within budget. If it is not we can help you adjust the specification to reach all performance, design and budgetary requirements.

## ADD US TO YOUR NBS SPECIFICATION

To assist you in specification we have created individual NBS Specification sheets for each Sieger® Systems product. These easy to navigate documents contain all the vital information needed for specification. They are available for you to complete on your own alternatively ask your sales representative at to complete this on your behalf.

## PLACE THE ORDER

When ready you (or your client or the builder) can then place the order for your products with us. A full in house handover will take place and your project will be passed to the contracts team. The project will be appointed a dedicated contracts manager who will oversee the installation process. The estimated lead time for Sieger® products is 6-8 weeks but your overall glazing lead time may be different depending on the other glazing products on your project and their lead times. Please also allow 20 working days if your project requires full glazing design drawings. This will be confirmed on order.

## WHERE CAN I SEE SIEGER PRODUCTS?

The Sieger® Systems range is available to view at the Sky House Design Centre. Just contact your sales representative who will be happy to book you an appointment.



# the legacy conservation rooflight

## EUROPEAN DESIGN

The Sieger® Architektursystem has been designed to the highest European standards to ensure a highly engineered finish with the best performance.

Each aluminium framing profile is selected and engineered to offer a minimal and modern finish, whilst maintaining robust performance and quality standards.

The technologically advanced thermal break system offers projects unparalleled levels of thermal insulation in keeping with modern European design.

## BRITISH MANUFACTURING

Every Sieger® Architektursystem products is manufactured and fabricated bespoke to each project specification. Our state of the art fabrication site offers the latest technology in modern aluminium fabrication, ensuring Sieger® Systems can offer efficient lead times and exceptional quality.

## MORE INFORMATION

For more information about the Sieger® Architektursystem please contact the team who will be happy to help. Make sure you investigate our entire range to achieve a cohesive design to all elements of your building project.



---

### **Factory**

Unit 9, Amersham Industrial Park  
Raans Road  
Amersham  
HP6 6FT, UK

### **Showroom**

Sky House Design Centre  
Raans Road  
Amersham  
HP6 6JQ, UK

01494 722 880

[sales@siegersystems.co.uk](mailto:sales@siegersystems.co.uk)  
[www.siegersystems.co.uk](http://www.siegersystems.co.uk)

facebook  
[www.facebook.com/siegeraluminiumsystems](https://www.facebook.com/siegeraluminiumsystems)

instagram  
[www.instagram.com/siegeraluminium](https://www.instagram.com/siegeraluminium)

part of the IQ® Glass Group

sieger®